

OPERATIONAL BLUEPRINT FOR SCHOOL REENTRY 2020-21

Updated 7/29/2020

Under ODE’s **Ready Schools, Safe Learners** guidance, each school¹ has been directed to submit a plan to the district² in order to provide on-site and/or hybrid instruction. Districts must submit each school’s plan to the local school board and make the plans available to the public. This form is to be used to document a district’s, school’s or program’s plan to ensure students can return for the 2020-21 school year, in some form, in accordance with Executive Order 20-25(10). Schools must use the [Ready Schools, Safe Learners guidance](#) document as they complete their Operational Blueprint for Reentry. ODE recommends plan development be inclusive of, but not limited to school-based administrators, teachers and school staff, health and nursing staff, association leadership, nutrition services, transportation services, tribal consultation,³ parents and others for purposes of providing expertise, developing broad understanding of the health protocols and carrying out plan implementation.

1. Please fill out information:

SCHOOL/DISTRICT/PROGRAM INFORMATION	
Name of School, District or Program	Albany Christian School
Key Contact Person for this Plan	Doug Tharp
Phone Number of this Person	W541.928.1110 C541.680.7037
Email Address of this Person	dtharp@albanychristian.org
Sectors and position titles of those who informed the plan	Preschool/Child Care Administration, K-8 Administration, Principal, Teachers, Staff, Parents, Board, Health & Safety Coordinator (HSC), Custodial Coordinator, Athletic Director, Distance Learning Coordinator (DLC)
Local public health office(s) or officers(s)	Shane Sanderson ssanderson@co.linn.or.us 541.967.3888 Rachel Peterson rpeterson@co.linn.or.us 541.967.3888 Dr. William Muth 541-768-5810 Todd Nobel tnobel@co.linn.or.us 541.967.3888 Neva Anderson nanderson@co.linn.or.us 541.730.9261 M-F 9-5
Name of person Designated to Establish, Implement and Enforce Physical Distancing Requirements	Mendy Hall
Intended Effective Dates for this Plan	September 8, 2020 - June 10, 2021
ESD Region	Linn County - GAPS

2. Please list efforts you have made to engage your community (public health information sharing, taking feedback on planning, etc.) in preparing for school in 2020-21. Include information on engagement

¹ For the purposes of this guidance: “school” refers to all public schools, including public charter schools, public virtual charter schools, alternative education programs, private schools and the Oregon School for the Deaf. For ease of readability, “school” will be used inclusively to reference all of these settings.

² For the purposes of this guidance: “district” refers to a school district, education service district, public charter school sponsoring district, virtual public charter school sponsoring district, state sponsored public charter school, alternative education programs, private schools, and the Oregon School for the Deaf.

³ Tribal Consultation is a separate process from stakeholder engagement; consultation recognizes and affirms tribal rights of self-government and tribal sovereignty, and mandates state government to work with American Indian nations on a [government-to-government](#) basis.



Albany Christian School

ACS Covid19 Prevention and Response Plan

Revised 10/30/2020

with communities often underserved and marginalized and those communities disproportionately impacted by COVID-19.

We have elicited opinions, judgments, conclusions, values, and preferences from parents and school staff via two school-wide surveys delivered using our email list of 554 addresses. We have been involved in collaborative staff deliberations regarding the results of those two surveys, forming conclusions and making preliminary statements of action in compliance with OHA guidelines for reopening procedures. We have presented a draft re-opening plan to both staff and parents for input, and have had one follow up meeting to review suggestions. We presented a Re-Opening Plan, based on this Operational Blueprint, to our school Board. The ACS School Board approved the Operational Blueprint and the ACS Re-Opening Plan on July 19, 2020. We have created a Health & Safety Coordinator (HSC) role who is collaborating with our LHPA and will maintain a close working relationship with that entity. We have created a Custodial Coordinator position to handle the increase in environmental cleaning. We are developing a High-Risk Student Distance Learning Coordinator (HRSDLC) job description and have identified a current staff member to assume that role to handle the specific needs of our “high risk” student population. The HSC will function, along with the Principal, as the primary persons for administering and monitoring the implementation of our re-opening plan. The ACS Board of Directors has reviewed results and conclusions and is part of the decision-making process.

As of March 2020, ACS has not had a school-related case of Covid-19 identified among our students or our staff. We have had one family diagnosed which was traced to a parent work-place of an off-campus distance learner and a Kindergartner. The distance learner has never been on campus and according to our records, the Kindergartner student displayed no Covid-19 symptoms while on campus prior to quarantine.

Therefore, our track record demonstrates that we have the ability to limit the transmission of the Covid-19 virus and as a result ACS will be transitioning our 6-8 grade to on-site learning as soon as a safe two-week-window emerges.

3. Indicate which instructional model will be used.

Select One:

On-Site Learning **Hybrid Learning** **Comprehensive Distance Learning**

4. If you selected Comprehensive Distance Learning, you only have to fill out the green portion of the Operational Blueprint for Reentry (i.e., page 2 in the initial template).
5. If you selected On-Site Learning or Hybrid Learning, you have to fill out the blue portion of the Operational Blueprint for Reentry (i.e., pages 3-16 in the initial template) and [submit online](https://app.smartsheet.com/b/form/a4dedb5185d94966b1dffc75e4874c8a). (<https://app.smartsheet.com/b/form/a4dedb5185d94966b1dffc75e4874c8a>) by August 17, 2020 or prior to the beginning of the 2020-21 school year.

* **Note:** Private schools are required to comply with only sections 1-3 of the *Ready Schools, Safe Learners* guidance.



Albany Christian School

ACS Covid19 Prevention and Response Plan

Revised 10/30/2020

REQUIREMENTS FOR COMPREHENSIVE DISTANCE LEARNING OPERATIONAL BLUEPRINT

This section must be completed by any school that is seeking to provide instruction through Comprehensive Distance Learning. Schools providing On-Site or Hybrid Instructional Models do not need to complete this section.

Describe why you are selecting Comprehensive Distance Learning as the school's Instructional Model for the effective dates of this plan.

In completing this portion of the Blueprint you are attesting that you have reviewed the Comprehensive Distance Learning Guidance. [Here is a link to the overview of CDL Requirements.](#) Please name any requirements you need ODE to review for any possible flexibility or waiver.

Describe the school's plan, including the anticipated timeline, for returning to Hybrid Learning or On-Site Learning consistent with the *Ready Schools, Safe Learners* guidance.

The remainder of this operational blueprint is not applicable to schools operating a Comprehensive Distance Learning Model.



Albany Christian School

ACS Covid19 Prevention and Response Plan

Revised 10/30/2020

ESSENTIAL REQUIREMENTS FOR HYBRID / ON-SITE OPERATIONAL BLUEPRINT

This section must be completed by any school that is providing instruction through On-Site or Hybrid Instructional Models. Schools providing Comprehensive Distance Learning Instructional Models do not need to complete this section.



1. Public Health Protocols

1a. COMMUNICABLE DISEASE MANAGEMENT PLAN FOR COVID-19

OHA/ODE Requirements	Hybrid/Onsite Plan
<ul style="list-style-type: none"> <input checked="" type="checkbox"/> Implement measures to limit the spread of COVID-19 within the school setting. <input checked="" type="checkbox"/> Update written Communicable Disease Management Plan to specifically address the prevention of the spread of COVID-19. <input checked="" type="checkbox"/> Designate a person at each school to establish, implement and enforce physical distancing requirements, consistent with this guidance and other guidance from OHA. <input checked="" type="checkbox"/> Include names of the LPHA staff, school nurses, and other medical experts who provided support and resources to the district/school policies and plans. Review relevant local, state, and national evidence to inform plan. <input checked="" type="checkbox"/> Process and procedures established to train all staff in sections 1 - 3 of the Ready Schools, Safe Learners guidance. Consider conducting the training virtually, or, if in-person, ensure physical distancing is maintained to the maximum extent possible. <input checked="" type="checkbox"/> Protocol to notify the local public health authority (LPHA Directory by County) of any confirmed COVID-19 cases among students or staff. <input checked="" type="checkbox"/> Plans for systematic disinfection of classrooms, offices, bathrooms and activity areas. <input checked="" type="checkbox"/> Process to report to the LPHA any cluster of any illness among staff or students. <input checked="" type="checkbox"/> Protocol to cooperate with the LPHA recommendations and provide all logs and information in a timely manner. <input checked="" type="checkbox"/> Protocol for screening students and staff for symptoms (see section 1f of the Ready Schools, Safe Learners guidance). <input checked="" type="checkbox"/> Protocol to isolate any ill or exposed persons from physical contact with others. <input checked="" type="checkbox"/> Protocol for communicating potential COVID-19 cases to the school community and other stakeholders (see section 1e of the Ready Schools, Safe Learners guidance). <input checked="" type="checkbox"/> Create a system for maintaining daily logs for each student/cohort for the purposes of contact tracing. This system needs to be made in consultation with a school/district nurse or an LPHA official. Sample logs are available as a part of the Oregon School Nurses Association COVID-19 Toolkit. 	<p>ACS will follow the ACS Communicable Disease Policy.</p> <p>ACS will follow the ACS Covid19 Prevention and Response Plan.</p> <p>Mendy Hall (ACS Health & Safety Coordinator) will establish, implement and enforce physical distancing requirements, consistent with this guidance and other guidance from OHA. Mendy Hall (ACS Health & Safety Coordinator) Neva Anderson nanderson@co.linn.or.us Dr. William Muth wmuth@samhealth.org Debby Uri duri@co.linn.or.us Adaline Padlina apadlina@co.linn.or.us See ACS Covid19 Prevention and Response Plan Section 1. Prevention</p> <p>See ACS Covid19 Prevention and Response Plan Section 2. Response</p> <p>See ACS Covid19 Prevention and Response Plan Section 1. Prevention</p> <p>See ACS Covid19 Prevention and Response Plan Section 2. Response</p> <p>See ACS Covid19 Prevention and Response Plan Section 2. Response</p> <p>See ACS Covid19 Prevention and Response Plan Section 1. Prevention</p> <p>See ACS Covid19 Prevention and Response Plan Section 2. Response</p> <p>See ACS Covid19 Prevention and Response Plan Section 2. Response</p> <p>See ACS Student Daily Contact Tracing Log</p>



Albany Christian School

ACS Covid19 Prevention and Response Plan

Revised 10/30/2020

OHA/ODE Requirements	Hybrid/Onsite Plan
<ul style="list-style-type: none"> If a student(s) is part of a stable cohort (a group of students that are consistently in contact with each other or in multiple cohort groups) that conform to the requirements of cohorting (see section 1d of the Ready Schools, Safe Learners guidance), the daily log may be maintained for the cohort. If a student(s) is not part of a stable cohort, then an individual student log must be maintained. <p><input checked="" type="checkbox"/> Required components of individual daily student/cohort logs include:</p> <ul style="list-style-type: none"> Child's name Drop off/pick up time Parent/guardian name and emergency contact information All staff (including itinerant staff, district staff, substitutes, and guest teachers) names and phone numbers who interact with a stable cohort or individual student <p><input checked="" type="checkbox"/> Protocol to record/keep daily logs to be used for contact tracing for a minimum of four weeks to assist the LPHA as needed.</p> <p><input checked="" type="checkbox"/> Process to ensure that all itinerant and all district staff (maintenance, administrative, delivery, nutrition, and any other staff) who move between buildings keep a log or calendar with a running four-week history of their time in each school building and who they were in contact with at each site.</p> <p><input checked="" type="checkbox"/> Process to ensure that the school reports to and consults with the LPHA regarding cleaning and possible classroom or program closure if anyone who has entered school is diagnosed with COVID-19.</p> <p><input checked="" type="checkbox"/> Protocol to respond to potential outbreaks (see section 3 of the Ready Schools, Safe Learners guidance).</p>	<p>See ACS Student Daily Contact Tracing Log</p> <p>See ACS Student Daily Contact Tracing Log</p> <p>N/A for ACS</p> <p>See ACS Student Daily Contact Tracing Log</p> <p>See ACS Covid19 Prevention and Response Plan Section 2. Response</p>

1b. HIGH-RISK POPULATIONS

OHA/ODE Requirements	Hybrid/Onsite Plan
<p><input checked="" type="checkbox"/> Serve students in high-risk population(s) whether learning is happening through On-Site, Hybrid (partially On-Site and partially Comprehensive Distance Learning models), or Comprehensive Distance Learning models.</p> <p>Medically Fragile, Complex and Nursing-Dependent Student Requirements</p> <p><input checked="" type="checkbox"/> All districts must account for students who have health conditions that require additional nursing services. Oregon law (ORS 336.201) defines three levels of severity related to required nursing services:</p> <ol style="list-style-type: none"> 1. Medically Complex: Are students who may have an unstable health condition and who may require daily professional nursing services. 	<p>See ACS Covid19 Prevention and Response Plan Section 1. Prevention</p> <p>ACS, as a private educational institution, does not have the resources to fully serve students of high-risk populations or the medically fragile and complex and nursing-dependent students. Families who need special services due to high-risk category needs will have the option to withdraw from ACS and be encouraged and helped to seek services through GAPS ESD</p>



Albany Christian School

ACS Covid19 Prevention and Response Plan

Revised 10/30/2020

OHA/ODE Requirements	Hybrid/Onsite Plan
<p><input checked="" type="checkbox"/> Staff and school administrators, in partnership with school nurses, or other school health providers, should work with interdisciplinary teams to address individual student needs. The school registered nurse (RN) is responsible for nursing care provided to individual students as outlined in ODE guidance and state law:</p> <ul style="list-style-type: none"> • Communicate with parents and health care providers to determine return to school status and current needs of the student. • Coordinate and update other health services the student may be receiving in addition to nursing services. This may include speech language pathology, occupational therapy, physical therapy, as well as behavioral and mental health services. • Modify Health Management Plans, Care Plans, IEPs, or 504 or other student-level medical plans, as indicated, to address current health care considerations. • The RN practicing in the school setting should be supported to remain up to date on current guidelines and access professional support such as evidence-based resources from the Oregon School Nurses Association. • Service provision should consider health and safety as well as legal standards. • Work with an interdisciplinary team to meet requirements of ADA and FAPE. • High-risk individuals may meet criteria for exclusion during a local health crisis. • Refer to updated state and national guidance and resources such as: <ul style="list-style-type: none"> ○ U.S. Department of Education Supplemental Fact Sheet: Addressing the Risk of COVID-19 in Preschool, Elementary and Secondary Schools While Serving Children with Disabilities from March 21, 2020. ○ ODE guidance updates for Special Education. Example from March 11, 2020. ○ OAR 581-015-2000 Special Education, requires districts to provide ‘school health services and school nurse services’ as part of the ‘related services’ in order ‘to assist a child with a disability to benefit from special education.’ ○ OAR 333-019-0010 Public Health: Investigation and Control of Diseases: General Powers and Responsibilities, outlines authority and responsibilities for school exclusion. 	<p>See High Risk Student/Staff Index</p> <p>Staff</p> <ul style="list-style-type: none"> • All staff identified as vulnerable by physician notification will have the option of taking a leave of absence, or being assigned to classroom Aide support, Preschool/Child Care support, or ACS Distance Learning support. • All staff will be given the opportunity to self-identify as vulnerable or living with a vulnerable family member. <p>Students</p> <ul style="list-style-type: none"> • All students will be given the opportunity to self-identify as vulnerable or living with a vulnerable family member. • All students identified as vulnerable by physician notification, will have the option to enroll in ACS Distance Learning with daily attendance check-ins. • ACS, as a private educational institution does not have the resources to serve students who experience a disability. <p>Visitors/Volunteers</p> <ul style="list-style-type: none"> • Visitors/Volunteers will be unable to work in schools, or complete other volunteer activities that require in person interaction, at this time. Adults in schools are limited to essential personnel only.



Albany Christian School

ACS Covid19 Prevention and Response Plan

Revised 10/30/2020

1c. PHYSICAL DISTANCING

OHA/ODE Requirements	Hybrid/Onsite Plan
<ul style="list-style-type: none"> ☒ Establish a minimum of 35 square feet per person when determining room capacity. Calculate only with usable classroom space, understanding that desks and room set-up will require use of all space in the calculation. This also applies for professional development and staff gatherings. ☒ Support physical distancing in all daily activities and instruction, maintaining at least six feet between individuals to the maximum extent possible. ☒ Minimize time standing in lines and take steps to ensure that six feet of distance between students is maintained, including marking spacing on floor, one-way traffic flow in constrained spaces, etc. ☒ Schedule modifications to limit the number of students in the building (e.g., rotating groups by days or location, staggered schedules to avoid hallway crowding and gathering). ☒ Plan for students who will need additional support in learning how to maintain physical distancing requirements. Provide instruction; don't employ punitive discipline. ☒ Staff should maintain physical distancing during all staff meetings and conferences, or consider web-based meetings. 	<p>See ACS Covid19 Prevention and Response Plan Addendum 4 for data</p> <p>See ACS Covid19 Prevention and Response Plan Section 1. Prevention:</p> <p>See ACS Covid19 Prevention and Response Plan Section 1. Prevention To address avoiding hallway crowding and gathering</p> <p>See ACS Covid19 Prevention and Response Plan Section 1. Protection & Section 3 REFERENCES: ADDENDUM #2 - Drop Off Maps & ADDENDUM #3 – Pick Up Maps.</p> <p>See ACS Covid19 Prevention and Response Plan Section 1. Prevention</p> <p>ACS Staff will meet via Zoom</p>

1d. COHORTING

OHA/ODE Requirements	Hybrid/Onsite Plan
<ul style="list-style-type: none"> ☒ Where feasible, establish stable cohorts: groups should be no larger than can be accommodated by the space available to provide 35 square feet per person, including staff. <ul style="list-style-type: none"> • The smaller the cohort, the less risk of spreading disease. As cohort groups increase in size, the risk of spreading disease increases. ☒ Students cannot be part of any cohort, or part of multiple cohorts that exceed a total of 100 people within the educational week. Schools should plan to limit cohort sizes to allow for efficient contact-tracing & minimal risk of exposure. ☒ Each school must have a system for daily logs to ensure contact tracing among the cohort (see section 1a of the <i>Ready Schools, Safe Learners</i> guidance). ☒ Minimize interaction between students in different stable cohorts (e.g., access to restrooms, activities, common areas). Provide access to All Gender/Gender Neutral restrooms. ☒ Cleaning and wiping surfaces (e.g., desks, door handles, etc.) must be maintained between multiple student uses, even in the same cohort. ☒ Design cohorts such that all students (including those protected under ADA and IDEA) maintain access to general education, grade level learning standards, and peers. ☒ Staff who interact with multiple stable cohorts must wash/sanitize their hands between interactions with different stable cohorts. 	<p>See ACS Covid19 Prevention and Response Plan Section 1. Prevention</p> <p>See ACS Covid19 Prevention and Response Plan Section 1. Prevention</p> <p>See Student Daily Contact Tracing Log</p> <p>See ACS Covid19 Prevention and Response Plan Section 1. Prevention and Section 3 Addendum #1</p> <p>See ACS Covid19 Prevention and Response Plan Section 1. Prevention</p> <p>See ACS Covid19 Prevention and Response Plan Section 1. Prevention</p> <p>See ACS Covid19 Prevention and Response Plan Section 1. Prevention</p>



Albany Christian School

ACS Covid19 Prevention and Response Plan

Revised 10/30/2020

1e. PUBLIC HEALTH COMMUNICATION

OHA/ODE Requirements	Hybrid/Onsite Plan
<ul style="list-style-type: none"> ☒ Communicate to staff at the start of On-Site instruction and at periodic intervals explaining infection control measures that are being implemented to prevent spread of disease. ☒ Develop protocols for communicating with students, families and staff who have come into close contact with a confirmed case. <ul style="list-style-type: none"> • The definition of exposure is being within 6 feet of a COVID-19 case for 15 minutes (or longer). ☒ Develop protocols for communicating immediately with staff, families, and the community when a new case(s) of COVID-19 is diagnosed in students or staff members, including a description of how the school or district is responding. ☒ Provide all information in languages and formats accessible to the school community. 	<p>See ACS STAFF LETTER</p> <p>See ACS Covid19 Prevention and Response Plan Section 2. Exposure</p> <p>See ACS Covid19 Prevention and Response Plan Section 2. Exposure</p> <p>The ACS HSC will coordinate with our LPHA to ensure information is accessible to the languages of the ACS school community.</p>

1f. ENTRY AND SCREENING

OHA/ODE Requirements	Hybrid/Onsite Plan
<ul style="list-style-type: none"> ☒ Direct students and staff to stay home if they, or anyone in their homes or community living spaces, have COVID-19 symptoms, or if anyone in their home or community living spaces has COVID-19. COVID-19 symptoms are as follows: <ul style="list-style-type: none"> • Primary symptoms of concern: cough, fever (of greater than 100.4°F) or chills, shortness of breath, or difficulty breathing. • Note that muscle pain, headache, sore throat, new loss of taste or smell, diarrhea, nausea, vomiting, nasal congestion, and runny nose are also symptoms often associated with COVID-19. More information about COVID-19 symptoms is available from CDC. • In addition to COVID-19 symptoms, students should be excluded from school for signs of other infectious diseases, per existing school policy and protocols. See pages 9-12 of OHA/ODE Communicable Disease Guidance. • Emergency signs that require immediate medical attention: <ul style="list-style-type: none"> ○ Trouble breathing ○ Persistent pain or pressure in the chest ○ New confusion or inability to awaken ○ Bluish lips or face ○ Other severe symptoms ☒ Screen all students and staff for symptoms on entry to bus/school every day. This can be done visually and/or with confirmation from a parent/caregiver/guardian. Staff members can self-screen and attest to their own health. <ul style="list-style-type: none"> • Anyone displaying or reporting the primary symptoms of concern must be isolated (see section 1i of the <i>Ready Schools, Safe Learners</i> guidance) and sent home as soon as possible. 	<p>See ACS Covid19 Prevention and Response Plan Section 1. Prevention</p> <p>ACS will provide first day of school training on Covid19 symptoms and follow CDC protocol for recognition and response.</p> <p>See ACS Covid19 Prevention and Response Plan Section 1. Prevention</p>



Albany Christian School

ACS Covid19 Prevention and Response Plan

Revised 10/30/2020

OHA/ODE Requirements	Hybrid/Onsite Plan
<ul style="list-style-type: none"> They must remain home until 24 hours after fever is gone (without use of fever reducing medicine) and other symptoms are improving. <p><input checked="" type="checkbox"/> Follow LPHA advice on restricting from school any student or staff known to have been exposed (e.g., by a household member) to COVID-19 within the preceding 14 calendar days.</p> <p><input checked="" type="checkbox"/> Staff or students with a chronic or baseline cough that has worsened or is not well-controlled with medication should be excluded from school. Do not exclude staff or students who have other symptoms that are chronic or baseline symptoms (e.g., asthma, allergies, etc.) from school.</p> <p><input checked="" type="checkbox"/> Hand hygiene on entry to school every day: wash with soap and water for 20 seconds or use an alcohol-based hand sanitizer with 60-95% alcohol.</p>	<p>See ACS Communicable Disease Policy & ACS Illness Policy</p> <p>See ACS Communicable Disease Policy & ACS Illness Policy</p> <p>See ACS Covid19 Prevention and Response Plan Section 1. Prevention</p>

1g. VISITORS/VOLUNTEERS

OHA/ODE Requirements	Hybrid/Onsite Plan
<p><input checked="" type="checkbox"/> Restrict non-essential visitors/volunteers.</p> <p><input checked="" type="checkbox"/> Visitors/volunteers must wash or sanitize their hands upon entry and exit.</p> <p><input checked="" type="checkbox"/> Visitors/volunteers must maintain six-foot distancing, wear face coverings, and adhere to all other provisions of this guidance.</p> <p><input checked="" type="checkbox"/> Screen all visitors/volunteers for symptoms upon every entry. Restrict from school property any visitor known to have been exposed to COVID-19 within the preceding 14 calendar days.</p>	<p>See ACS Covid19 Prevention and Response Plan Section 1. Prevention</p> <p>See ACS Covid19 Prevention and Response Plan Section 1. Prevention</p> <p>See ACS Covid19 Prevention and Response Plan Section 1. Prevention</p> <p>See ACS Covid19 Prevention and Response Plan Section 1. Prevention</p>

1h. FACE COVERINGS, FACE SHIELDS, AND CLEAR PLASTIC BARRIERS

OHA/ODE Requirements	Hybrid/Onsite Plan
<p><input checked="" type="checkbox"/> Face coverings or face shields for all staff, contractors, other service providers, or visitors or volunteers following CDC guidelines Face Coverings.</p> <p><input checked="" type="checkbox"/> Face coverings or face shields for all students in grades Kindergarten and up following CDC guidelines Face Coverings.</p> <p><input checked="" type="checkbox"/> If a student removes a face covering, or demonstrates a need to remove the face covering for a short-period of time, the school/team must:</p> <p><input checked="" type="checkbox"/> Face masks for school RNs or other medical personnel when providing direct contact care and monitoring of staff/students displaying symptoms. School nurses should also wear appropriate Personal Protective Equipment (PPE) for their role.</p> <p>Protections under the ADA or IDEA</p> <p><input checked="" type="checkbox"/> If any student requires an accommodation to meet the requirement for face coverings, districts and schools should work to limit the student's proximity to students and staff to the extent possible to minimize the possibility of exposure. Appropriate accommodations could include:</p> <ul style="list-style-type: none"> Offering different types of face coverings and face shields that may meet the needs of the student. 	<p>See ACS Covid19 Prevention and Response Plan Section 1. Prevention</p> <p>See ACS Covid19 Prevention and Response Plan Section 1. Prevention</p> <p>See ACS Covid19 Prevention and Response Plan Section 1. Prevention</p> <p>See ACS Covid19 Prevention and Response Plan Section 1. Prevention</p> <p>See ACS Covid19 Prevention and Response Plan Section 1. Prevention</p>



Albany Christian School

ACS Covid19 Prevention and Response Plan

Revised 10/30/2020

OHA/ODE Requirements	Hybrid/Onsite Plan
<ul style="list-style-type: none"> • Spaces away from peers while the face covering is removed; students should not be left alone or unsupervised. • Short periods of the educational day that do not include wearing the face covering, while following the other health strategies to reduce the spread of disease; • Additional instructional supports to effectively wear a face covering; <p>☒ For students with existing medical conditions, doctor’s orders to not wear face coverings, or other health related concerns, schools/districts must not deny access to On-Site instruction.</p> <p>☒ Schools and districts must comply with the established IEP/504 plan prior to the closure of in-person instruction in March of 2020.</p> <ul style="list-style-type: none"> • If a student eligible for, or receiving services under a 504/IEP, cannot wear a face covering due to the nature of the disability, the school or district must: <ol style="list-style-type: none"> 1. Review the 504/IEP to ensure access to instruction in a manner comparable to what was originally established in the student’s plan including on-site instruction with accommodations or adjustments. 2. Placement determinations cannot be made due solely to the inability to wear a face covering. 3. Plans should include updates to accommodations and modifications to support students. • Students protected under ADA/IDEA, who abstain from wearing a face covering, or students whose families determine the student will not wear a face covering, the school or district must: <ol style="list-style-type: none"> 1. Review the 504/IEP to ensure access to instruction in a manner comparable to what was originally established in the student’s plan. 2. The team must determine that the disability is not prohibiting the student from meeting the requirement. <ul style="list-style-type: none"> ▪ If the team determines that the disability is prohibiting the student from meeting the requirement, follow the requirements for students eligible for, or receiving services under, a 504/IEP who cannot wear a face covering due to the nature of the disability, ▪ If a student’s 504/IEP plan included supports/goals/instruction for behavior or social emotional learning, the school team must evaluate the student’s plan prior to 	<p>See ACS Covid19 Prevention and Response Plan Section 1. Prevention</p> <p>N/A for ACS</p>



Albany Christian School

ACS Covid19 Prevention and Response Plan

Revised 10/30/2020

OHA/ODE Requirements	Hybrid/Onsite Plan
<p>providing instruction through Comprehensive Distance Learning.</p> <p>3. Hold a 504/IEP meeting to determine equitable access to educational opportunities which may include limited on-site instruction, on-site instruction with accommodations, or Comprehensive Distance Learning.</p> <p><input checked="" type="checkbox"/> Districts must consider child find implications for students who are not currently eligible for, or receiving services under, a 504/IEP who demonstrate an inability to consistently wear a face covering or face shield as required. Ongoing inability to meet this requirement may be evidence of the need for an evaluation to determine eligibility for support under IDEA or Section 504.</p> <p><input checked="" type="checkbox"/> If a staff member requires an accommodation for the face covering or face shield requirements, districts and schools should work to limit the staff member's proximity to students and staff to the extent possible to minimize the possibility of exposure.</p>	<p>N/A for ACS</p> <p>See ACS Covid19 Prevention and Response Plan Section 1. Prevention</p>

1i. ISOLATION MEASURES

OHA/ODE Requirements	Hybrid/Onsite Plan
<p><input checked="" type="checkbox"/> Protocols for exclusion and isolation for sick students and staff whether identified at the time of bus pick-up, arrival to school, or at any time during the school day.</p> <p><input checked="" type="checkbox"/> Protocols for screening students, as well as exclusion and isolation protocols for sick students and staff identified at the time of arrival or during the school day.</p> <ul style="list-style-type: none"> • Work with school nurses, health care providers, or other staff with expertise to determine necessary modifications to areas where staff/students will be isolated. • Consider required physical arrangements to reduce risk of disease transmission. • Plan for the needs of generally well students who need medication or routine treatment, as well as students who may show signs of illness. <p><input checked="" type="checkbox"/> Students and staff who report or develop symptoms must be isolated in a designated isolation area in the school, with adequate space and staff supervision and symptom monitoring by a school nurse, other school-based health care provider or school staff until they are able to go home. Anyone providing supervision and symptom monitoring must wear appropriate face covering or face shields.</p> <ul style="list-style-type: none"> • School nurse and health staff in close contact with symptomatic individuals (less than six feet) should wear a medical-grade face mask. Other Personal Protective Equipment (PPE) may be needed depending on symptoms and care provided. Consult a nurse or health care professional regarding appropriate use of PPE. Any PPE used 	<p>ACS will follow the ACS Covid19 Prevention and Response Plan for suspected of COVID19 exposure. Students will be referred to parents and the LPHA for COVID19 testing.</p> <p>ACS will follow the ACS Covid19 Prevention and Response Plan for suspected of COVID19 exposure. Students will be referred to parents and the LPHA for COVID19 testing</p> <p>See ACS Covid19 Prevention and Response Plan Section 2. Response</p>



Albany Christian School

ACS Covid19 Prevention and Response Plan

Revised 10/30/2020

OHA/ODE Requirements	Hybrid/Onsite Plan
<p>during care of a symptomatic individual should be properly removed and disposed of prior to exiting the care space.</p> <ul style="list-style-type: none"> • After removing PPE, hands should be immediately cleaned with soap and water for at least 20 seconds. If soap and water are not available, hands can be cleaned with an alcohol-based hand sanitizer that contains 60-95% alcohol. • If able to do so safely, a symptomatic individual should wear a face covering. • To reduce fear, anxiety, or shame related to isolation, provide a clear explanation of procedures, including use of PPE and handwashing. <p><input checked="" type="checkbox"/> Establish procedures for safely transporting anyone who is sick to their home or to a health care facility.</p> <p><input checked="" type="checkbox"/> Staff and students who are ill must stay home from school and must be sent home if they become ill at school, particularly if they have COVID-19 symptoms.</p> <ul style="list-style-type: none"> • Symptomatic staff or students should be evaluated and seek COVID-19 testing from their regular physician or through the local public health authority. • If they have a positive COVID-19 viral (PCR) test result, the person should remain home for at least 10 days after illness onset and 24 hours after fever is gone, without use of fever reducing medicine, and other symptoms are improving. • If they have a negative COVID-19 viral test (and if they have multiple tests, all tests are negative), they should remain home until 24 hours after fever is gone, without use of fever reducing medicine, and other symptoms are improving. • If a clear alternative diagnosis is identified as the cause of the person's illness (e.g., a positive strep throat test), then usual disease-specific return-to-school guidance should be followed and person should be fever-free for 24 hours, without use of fever reducing medicine. A physician note is required to return to school, to ensure that the person is not contagious. • If they do not undergo COVID-19 testing, the person should remain at home for 10 days and until 24 hours after fever is gone, without use of fever reducing medicine, and other symptoms are improving. <p><input checked="" type="checkbox"/> Involve school nurses, School Based Health Centers, or staff with related experience (Occupational or Physical Therapists) in development of protocols and assessment of symptoms (where staffing exists).</p> <p><input checked="" type="checkbox"/> Record and monitor the students and staff being isolated or sent home for the LPHA review.</p>	<p>ACS will call parents to transport, follow CDC Guidelines and report to LPHA See ACS Communicable Disease Policy & ACS Illness Policy</p> <p>ACS' HSC will coordinate with LPHA</p> <p>See ACS Covid19 Prevention and Response Plan Section 2. Response</p>



Albany Christian School

ACS Covid19 Prevention and Response Plan

Revised 10/30/2020



2. Facilities and School Operations

Some activities and areas will have a higher risk for spread (e.g., band, choir, science labs, locker rooms). When engaging in these activities within the school setting, schools will need to consider additional physical distancing or conduct the activities outside (where feasible). Additionally, schools should consider sharing explicit risk statements for higher risk activities (see section 5f of the *Ready Schools, Safe Learners* guidance).

2a. ENROLLMENT

(Note: Section 2a does not apply to private schools.)

OHA/ODE Requirements	Hybrid/Onsite Plan
<input checked="" type="checkbox"/> Enroll all students (includes foreign exchange students) following the standard Oregon Department of Education guidelines.	See ACS Student Admission and Enrollment Policy
<input checked="" type="checkbox"/> Do not disenroll students for non-attendance if they meet the following conditions: <ul style="list-style-type: none"> • Are identified as high-risk, or otherwise considered to be part of a population vulnerable to infection with COVID-19, or • Have COVID-19 symptoms for 10 consecutive school days or longer. 	See ACS Student Admission and Enrollment Policy Section VI.1: COVID19 Exceptions
<input checked="" type="checkbox"/> Design attendance policies to account for students who do not attend in-person due to student or family health and safety concerns.	See ACS Student Admission and Enrollment Policy Section VI.2: COVID19 Exceptions

2b. ATTENDANCE

(Note: Section 2b does not apply to private schools.)

OHA/ODE Requirements	Hybrid/Onsite Plan
<input checked="" type="checkbox"/> Grades K-5: Attendance must be taken at least once per day for all students enrolled in school, regardless of the instructional model (On-Site, Hybrid, Comprehensive Distance Learning).	See ACS Covid19 Prevention and Response Plan Section 2. Response
<input checked="" type="checkbox"/> Grades 6-12: Attendance must be taken at least once for each scheduled class that day for all students enrolled in school, regardless of the instructional model (On-Site, Hybrid, Comprehensive Distance Learning).	See ACS Covid19 Prevention and Response Plan Section 2. Response
<input checked="" type="checkbox"/> Provide families with clear and concise descriptions of student attendance and participation expectations as well as family involvement expectations that take into consideration the home environment, caregiver's work schedule, and mental/physical health.	See ACS Covid19 Prevention and Response Plan Section 2. Response



Albany Christian School

ACS Covid19 Prevention and Response Plan

Revised 10/30/2020

2c. TECHNOLOGY

OHA/ODE Requirements	Hybrid/Onsite Plan
<ul style="list-style-type: none"> ☒ Update procedures for district-owned or <i>school-owned</i> devices to match cleaning requirements (see section 2d of the <i>Ready Schools, Safe Learners</i> guidance). ☒ Procedures for return, inventory, updating, and redistributing district-owned devices must meet physical distancing requirements. 	<p>See ACS Covid19 Prevention and Response Plan Section 1. Prevention</p> <p>See ACS Covid19 Prevention and Response Plan Section 1. Prevention</p>

2d. SCHOOL SPECIFIC FUNCTIONS/FACILITY FEATURES

OHA/ODE Requirements	Hybrid/Onsite Plan
<ul style="list-style-type: none"> ☒ Handwashing: All people on campus should be advised and encouraged to wash their hands frequently. ☒ Equipment: Develop and use sanitizing protocols for all equipment used by more than one individual or purchase equipment for individual use. ☒ Events: Cancel, modify, or postpone field trips, assemblies, athletic events, practices, special performances, school-wide parent meetings and other large gatherings to meet requirements for physical distancing. ☒ Transitions/Hallways: Limit transitions to the extent possible. Create hallway procedures to promote physical distancing and minimize gatherings. ☒ Personal Property: Establish policies for personal property being brought to school (e.g., refillable water bottles, school supplies, headphones/earbuds, cell phones, books, instruments, etc.). If personal items are brought to school, they must be labeled prior to entering school and use should be limited to the item owner. 	<ul style="list-style-type: none"> ● Handwashing: See ACS Covid19 Prevention and Response Plan Section 1. Prevention ● Equipment: See ACS Covid19 Prevention and Response Plan Section 1. Prevention ● Events: See ACS Covid19 Prevention and Response Plan Section 2. Response ● Transitions/Hallways: See ACS Covid19 Prevention and Response Plan Section 1. Prevention ● Personal Property: See ACS Covid19 Prevention and Response Plan Section 1. Prevention

2e. ARRIVAL AND DISMISSAL

OHA/ODE Requirements	Hybrid/Onsite Plan
<ul style="list-style-type: none"> ☒ Physical distancing, stable cohorts, square footage, and cleaning requirements must be maintained during arrival and dismissal procedures. ☒ Create schedule(s) and communicate staggered arrival and/or dismissal times. ☒ Assign students or cohorts to an entrance; assign staff member(s) to conduct visual screenings (see section 1f of the <i>Ready Schools, Safe Learners</i> guidance). ☒ Ensure accurate sign-in/sign-out protocols to help facilitate contact tracing by the LPHA. Sign-in procedures are not a replacement for entrance and screening requirements. Students entering school after arrival times must be screened for the primary symptoms of concern. <ul style="list-style-type: none"> ● Eliminate shared pen and paper sign-in/sign-out sheets. ● Ensure hand sanitizer is available if signing children in or out on an electronic device. ☒ Ensure hand sanitizer dispensers are easily accessible near all entry doors and other high-traffic areas. Establish and clearly communicate procedures for keeping caregiver drop-off/pick-up as brief as possible. 	<p>See ACS Covid19 Prevention and Response Plan Section 1. Prevention & Section 3. References: Addendum #4</p> <p>See ACS Covid19 Prevention and Response Plan Section 3. References: Addendum #1</p> <p>See ACS Covid19 Prevention and Response Plan Section 1. Prevention & Section 3. References: Addendum #3 & #4;</p> <p>See ACS Covid19 Prevention and Response Plan Section 3. References: Addendum #2 & Addendum #5; Section 1. Prevention</p> <p>See ACS Covid19 Prevention and Response Plan Section 1. Prevention</p>

2f. CLASSROOMS/REPURPOSED LEARNING SPACES



Albany Christian School

ACS Covid19 Prevention and Response Plan

Revised 10/30/2020

OHA/ODE Requirements	Hybrid/Onsite Plan
<p>☒ Seating: Rearrange student desks and other seat spaces so that staff and students' physical bodies are six feet apart to the maximum extent possible while also maintaining 35 square feet per person; assign seating so students are in the same seat at all times.</p> <p>☒ Materials: Avoid sharing of community supplies when possible (e.g., scissors, pencils, etc.). Clean these items frequently. Provide hand sanitizer and tissues for use by students and staff.</p> <p>☒ Handwashing: Remind students (with signage and regular verbal reminders from staff) of the utmost importance of hand hygiene and respiratory etiquette. Respiratory etiquette means covering coughs and sneezes with an elbow or a tissue. Tissues should be disposed of in a garbage can, then hands washed or sanitized immediately.</p> <ul style="list-style-type: none"> • Wash hands with soap and water for 20 seconds or use an alcohol-based hand sanitizer with 60-95% alcohol. 	<p>Seating: See ACS Covid19 Prevention and Response Plan Section 1. Prevention</p> <p>Materials: See ACS Covid19 Prevention and Response Plan Section 1. Prevention</p> <p>Handwashing: See ACS Covid19 Prevention and Response Plan Section 1. Prevention</p>

2g. PLAYGROUNDS, FIELDS, RECESS, BREAKS, AND RESTROOMS

OHA/ODE Requirements	Hybrid/Onsite Plan
<p>☒ Keep school playgrounds closed to the general public until park playground equipment and benches reopen in the community (see Oregon Health Authority's Specific Guidance for Outdoor Recreation Organizations).</p> <p>☒ After using the restroom students must wash hands with soap and water for 20 seconds. Soap must be made available to students and staff.</p> <p>☒ Before and after using playground equipment, students must wash hands with soap and water for 20 seconds <u>or</u> use an alcohol-based hand sanitizer with 60-95% alcohol.</p> <p>☒ Designate playground and shared equipment solely for the use of one cohort at a time. Disinfect at least daily or between use as much as possible in accordance with CDC guidance.</p> <p>☒ Cleaning requirements must be maintained (see section 2j of the <i>Ready Schools, Safe Learners</i> guidance).</p> <p>☒ Maintain physical distancing requirements, stable cohorts, and square footage requirements.</p> <p>☒ Provide signage and restrict access to outdoor equipment (including sports equipment, etc.).</p> <p>☒ Design recess activities that allow for physical distancing and maintenance of stable cohorts.</p> <p>☒ Clean all outdoor equipment at least daily or between use as much as possible in accordance with CDC guidance.</p> <p>☒ Limit staff rooms, common staff lunch areas, and workspaces to single person usage at a time, maintaining six feet of distance between adults.</p>	<p>See ACS Covid19 Prevention and Response Plan Section 1. Prevention</p> <p>See ACS Covid19 Prevention and Response Plan Section 1. Prevention</p> <p>See ACS Covid19 Prevention and Response Plan Section 1. Prevention</p> <p>See ACS Covid19 Prevention and Response Plan Section 1. Prevention</p> <p>See ACS Covid19 Prevention and Response Plan Section 1. Prevention</p> <p>See ACS Covid19 Prevention and Response Plan Section 1. Prevention</p> <p>See ACS Covid19 Prevention and Response Plan Section 1. Prevention</p> <p>See ACS Covid19 Prevention and Response Plan Section 1. Prevention</p> <p>See ACS Covid19 Prevention and Response Plan Section 1. Prevention</p> <p>See ACS Covid19 Prevention and Response Plan Section 1. Prevention</p>



Albany Christian School

ACS Covid19 Prevention and Response Plan

Revised 10/30/2020

2h. MEAL SERVICE/NUTRITION

OHA/ODE Requirements	Hybrid/Onsite Plan
<ul style="list-style-type: none"> ☒ Include meal services/nutrition staff in planning for school reentry. ☒ Staff serving meals must wear face shields or face covering (see section 1h of the <i>Ready Schools, Safe Learners</i> guidance). ☒ Students must wash hands with soap and water for 20 seconds <u>or</u> use an alcohol-based hand sanitizer with 60-95% alcohol before meals and should be encouraged to do so after. ☒ Appropriate daily cleaning of meal items (e.g., plates, utensils, transport items) in classrooms where meals are consumed. ☒ Cleaning and sanitizing of meal touch-points and meal counting system between stable cohorts. ☒ Adequate cleaning of tables between meal periods. ☒ Since staff must remove their face coverings during eating and drinking, staff should eat snacks and meals independently, and not in staff rooms when other people are present. Consider staggering times for staff breaks, to prevent congregation in shared spaces. 	<p>See ACS Covid19 Prevention and Response Plan Section 1. Prevention</p> <p>See ACS Covid19 Prevention and Response Plan Section 1. Prevention</p> <p>See ACS Covid19 Prevention and Response Plan Section 1. Prevention</p> <p>See ACS Covid19 Prevention and Response Plan Section 1. Prevention</p> <p>See ACS Covid19 Prevention and Response Plan Section 1. Prevention</p> <p>See ACS Covid19 Prevention and Response Plan Section 1. Prevention</p> <p>See ACS Covid19 Prevention and Response Plan Section 1. Prevention</p>

2i. TRANSPORTATION

OHA/ODE Requirements	Hybrid/Onsite Plan
<ul style="list-style-type: none"> ☒ Include transportation departments (and associated contracted providers, if used) in planning for return to service. ☒ Buses are cleaned frequently. Conduct targeted cleanings between routes, with a focus on disinfecting frequently touched surfaces of the bus (see section 2j of the <i>Ready Schools, Safe Learners</i> guidance). ☒ Develop protocol for loading/unloading that includes visual screening for students exhibiting symptoms and logs for contact-tracing. This can be done at the time of arrival and departure. <ul style="list-style-type: none"> • If a student displays COVID-19 symptoms, provide a face shield or face covering (unless they are already wearing one) and keep six feet away from others. Continue transporting the student. • If arriving at school, notify staff to begin isolation measures. <ul style="list-style-type: none"> ○ If transporting for dismissal and the student displays an onset of symptoms, notify the school. ☒ Consult with parents/guardians of students who may require additional support (e.g., students who experience a disability and require specialized transportation as a related service) to appropriately provide service. ☒ Drivers wear face shields or face coverings when not actively driving and operating the bus. ☒ Inform parents/guardians of practical changes to transportation service (i.e., physical distancing at bus stops and while loading/unloading, potential for increased route 	<p>N/A for ACS</p> <p>N/A for ACS</p> <p>N/A for ACS</p> <p>N/A for ACS</p> <p>N/A for ACS</p> <p>N/A for ACS</p> <p>N/A for ACS</p>



Albany Christian School

ACS Covid19 Prevention and Response Plan

Revised 10/30/2020

OHA/ODE Requirements	Hybrid/Onsite Plan
<p>time due to additional precautions, sanitizing practices, and face coverings).</p> <p><input checked="" type="checkbox"/> Face coverings or face shields for all students in grades Kindergarten and up following CDC guidelines applying the guidance in section 1h of the <i>Ready Schools, Safe Learners</i> guidance to transportation settings.</p>	N/A for ACS

2j. CLEANING, DISINFECTION, AND VENTILATION

OHA/ODE Requirements	Hybrid/Onsite Plan
<p><input checked="" type="checkbox"/> Clean, sanitize, and disinfect frequently touched surfaces (e.g., playground equipment, door handles, sink handles, drinking fountains, transport vehicles) and shared objects (e.g., toys, games, art supplies) between uses multiple times per day. Maintain clean and disinfected (CDC guidance) environments, including classrooms, cafeteria settings and restrooms.</p> <p><input checked="" type="checkbox"/> Clean and disinfect playground equipment at least daily or between use as much as possible in accordance with CDC guidance.</p> <p><input checked="" type="checkbox"/> Apply disinfectants safely and correctly following labeling direction as specified by the manufacturer. Keep these products away from students.</p> <p><input checked="" type="checkbox"/> To reduce the risk of asthma, choose disinfectant products on the EPA List N with asthma-safer ingredients (e.g. hydrogen peroxide, citric acid, or lactic acid) and avoid products that mix these with asthma-causing ingredients like peroxyacetic acid, sodium hypochlorite (bleach), or quaternary ammonium compounds.</p> <p><input checked="" type="checkbox"/> Operate ventilation systems properly and/or increase circulation of outdoor air as much as possible by opening windows and doors, using fans, and through other methods. Consider running ventilation systems continuously and changing the filters more frequently. Do <u>not</u> use fans if they pose a safety or health risk, such as increasing exposure to pollen/allergies or exacerbating asthma symptoms. For example, do not use fans if doors and windows are closed and the fans are recirculating the classroom air.</p> <p><input checked="" type="checkbox"/> Consider the need for increased ventilation in areas where students with special health care needs receive medication or treatments.</p> <p><input checked="" type="checkbox"/> Facilities should be cleaned and disinfected at least daily to prevent transmission of the virus from surfaces (see CDC's guidance on disinfecting public spaces).</p> <p><input checked="" type="checkbox"/> Air circulation and filtration are helpful factors in reducing airborne viruses. Consider modification or enhancement of building ventilation where feasible (see CDC's guidance on ventilation and filtration and American Society of Heating, Refrigerating, and Air-Conditioning Engineers' guidance).</p>	<p>See ACS Covid19 Prevention and Response Plan Section 1. Prevention & ACS Covid19 Cleaning Policy</p> <p>See ACS Covid19 Prevention and Response Plan Section 1. Prevention & ACS Covid19 Cleaning Policy</p> <p>See ACS Covid19 Cleaning Policy</p> <p>See ACS Covid19 Cleaning Policy</p> <p>See ACS Covid19 Cleaning Policy</p> <p>See ACS Covid19 Cleaning Policy</p> <p>See ACS Covid19 Cleaning Policy</p> <p>See ACS Covid19 Cleaning Policy</p>



Albany Christian School

ACS Covid19 Prevention and Response Plan

Revised 10/30/2020

2k. HEALTH SERVICES

OHA/ODE Requirements	Hybrid/Onsite Plan
<p><input checked="" type="checkbox"/> OAR 581-022-2220 Health Services, requires districts to “maintain a prevention-oriented health services program for all students” including space to isolate sick students and services for students with special health care needs. While OAR 581-022-2220 does not apply to private schools, private schools must provide a space to isolate sick students and provide services for students with special health care needs.</p> <p><input checked="" type="checkbox"/> Licensed, experienced health staff should be included on teams to determine district health service priorities. Collaborate with health professionals such as school nurses; SBHC staff; mental and behavioral health providers; physical, occupational, speech, and respiratory therapists; and School Based Health Centers (SBHC).</p>	<p>See ACS Covid19 Prevention and Response Plan Section 1. Prevention</p> <p>See ACS Health and Safety Coordinator Job Description ACS HSC will coordinate with LPHA</p> <p>See ACS Health and Safety Coordinator Job Description</p>

2l. BOARDING SCHOOLS AND RESIDENTIAL PROGRAMS ONLY

OHA/ODE Requirements	Hybrid/Onsite Plan
<p><input checked="" type="checkbox"/> Provide specific plan details and adjustments in Operational Blueprints that address staff and student safety, which includes how you will approach:</p> <ul style="list-style-type: none"> • Contact tracing • The intersection of cohort designs in residential settings (by wing or common restrooms) with cohort designs in the instructional settings. The same cohorting parameter limiting total cohort size to 100 people applies. • Quarantine of exposed staff or students • Isolation of infected staff or students • Communication and designation of where the “household” or “family unit” applies to your residents and staff <p><input checked="" type="checkbox"/> Review and take into consideration CDC guidance for shared or congregate housing:</p> <ul style="list-style-type: none"> • Not allow more than two students to share a residential dorm room unless alternative housing arrangements are impossible • Ensure at least 64 square feet of room space per resident • Reduce overall residential density to ensure sufficient space for the isolation of sick or potentially infected individuals, as necessary; • Configure common spaces to maximize physical distancing; • Provide enhanced cleaning; • Establish plans for the containment and isolation of on-campus cases, including consideration of PPE, food delivery, and bathroom needs. 	<p>N/A for ACS</p> <p>N/A for ACS</p>



Albany Christian School

ACS Covid19 Prevention and Response Plan

Revised 10/30/2020



3. Response to Outbreak

3a. PREVENTION AND PLANNING

OHA/ODE Requirements	Hybrid/Onsite Plan
<ul style="list-style-type: none"> <input checked="" type="checkbox"/> Coordinate with Local Public Health Authority (LPHA) to establish communication channels related to current transmission level. <input checked="" type="checkbox"/> Establish a specific emergency response framework with key stakeholders. <input checked="" type="checkbox"/> When new cases are identified in the school setting, and the incidence is low, the LPHA will provide a direct report to the district nurse, or designated staff, on the diagnosed case(s). Likewise, the LPHA will impose restrictions on contacts. 	<p>ACS HSC began coordinating 6/17/2020</p> <p>ACS will follow the school's ACS Covid19 Prevention and Response Plan and coordinate with the LPHA for any outbreak response.</p> <p>ACS will follow the school's ACS Covid19 Prevention and Response Plan and coordinate with the LPHA for any outbreak response.</p>

3b. RESPONSE

OHA/ODE Requirements	Hybrid/Onsite Plan
<ul style="list-style-type: none"> <input checked="" type="checkbox"/> Follow the district's or school's outbreak response protocol. Coordinate with the LPHA for any outbreak response. <input checked="" type="checkbox"/> If anyone who has been on campus is known to have been diagnosed with COVID-19, report the case to and consult with the LPHA regarding cleaning and possible classroom or program closure. <ul style="list-style-type: none"> • Determination if exposures have occurred • Cleaning and disinfection guidance • Possible classroom or program closure <input checked="" type="checkbox"/> Report to the LPHA any cluster of illness (2 or more people with similar illness) among staff or students. <input checked="" type="checkbox"/> When cases are identified in the local region, a response team should be assembled within the district and responsibilities assigned within the district. <input checked="" type="checkbox"/> Modify, postpone, or cancel large school events as coordinated with the LPHA. <input checked="" type="checkbox"/> If the school is closed, implement Short-Term Distance Learning or Comprehensive Distance Learning models for all staff/students. <input checked="" type="checkbox"/> Continue to provide meals for students. <input checked="" type="checkbox"/> Communicate criteria that must be met in order for On-Site instruction to resume and relevant timelines with families. 	<p>ACS will follow the school's Covid19 Prevention and Response Plan and coordinate with the LPHA for any outbreak response.</p> <p>ACS Will follow LPHA guidelines regarding cleaning and possible classroom or program closure.</p> <p>See ACS Health and Safety Coordinator Job Description</p> <p>See ACS Health and Safety Coordinator Job Description</p> <p>See ACS Covid19 Prevention and Response Plan Section 2. Exposure</p> <p>See ACS Covid19 Prevention and Response Plan Section 2. Exposure</p> <p>N/A for ACS</p> <p>See ACS Covid19 Prevention and Response Plan Section 2. Exposure</p>

3c. RECOVERY AND REENTRY

OHA/ODE Requirements	Hybrid/Onsite Plan
<ul style="list-style-type: none"> <input checked="" type="checkbox"/> Plan instructional models that support all learners in Comprehensive Distance Learning. <input checked="" type="checkbox"/> Clean, sanitize, and disinfect surfaces (e.g., playground equipment, door handles, sink handles, drinking fountains, transport vehicles) and follow CDC guidance for classrooms, cafeteria settings, restrooms, and playgrounds. 	<p>ACS will follow CDC guidance</p> <p>See ACS Covid19 Prevention and Response Plan Section 1. Prevention</p>



Albany Christian School

ACS Covid19 Prevention and Response Plan

Revised 10/30/2020

OHA/ODE Requirements	Hybrid/Onsite Plan
<input checked="" type="checkbox"/> Communicate with families about options and efforts to support returning to On-Site instruction. <input checked="" type="checkbox"/> Follow the LPHA guidance to begin bringing students back into On-Site instruction. <ul style="list-style-type: none"> Consider smaller groups, cohorts, and rotating schedules to allow for a safe return to schools. 	See ACS Covid19 Prevention and Response Plan Section 2. Exposure ACS will strive to follow LPHA guidelines regarding bringing students back into On-Site instruction.



ASSURANCES

This section must be completed by any public school that is providing instruction through On-Site or Hybrid Instructional Models. Schools providing Comprehensive Distance Learning Instructional Models do not need to complete this section. This section does not apply to private schools.

- We affirm that our school plan has met the requirements from ODE guidance for sections 4, 5, 6, 7, and 8 of the **Ready Schools, Safe Learners** guidance.
- We affirm that we cannot meet all of the ODE requirements for sections 4, 5, 6, 7 and/or 8 of the **Ready Schools, Safe Learners** guidance at this time. We will continue to work towards meeting them and have noted and addressed which requirement(s) we are unable to meet in the table titled "Assurance Compliance and Timeline" below.



4. Equity



5. Instruction



6. Family, Community, Engagement



7. Mental, Social, and Emotional Health



8. Staffing and Personnel



Albany Christian School

ACS Covid19 Prevention and Response Plan
Revised 10/30/2020

ACS Covid19 Prevention and Response Plan K-3

8/15/2020

Revised 10/1/2020

Revised 10/30/2020





Albany Christian School

ACS Covid19 Prevention and Response Plan

Revised 10/30/2020

Introduction

“COVID-19 is caused by a coronavirus called SARS-CoV-2. Older adults and people who have severe underlying medical conditions like heart or lung disease or diabetes seem to be at higher risk for developing more serious complications from COVID-19 illness.”- “While fewer children have been sick with COVID-19 compared to adults, most children with COVID-19 have mild symptoms or have no symptoms at all. “ (CDC.gov)⁴

ACS currently offers on-site instruction five days a week for grades K-3 per the original exception clause allowable in August. Following the new metrics outlined by the governor’s office on October 30, 2020, ACS is planning to offer on-site instruction five days a week for our remaining grades 4-8 with continued health and safety accommodations in place after 14 days of meeting the newest metrics.

The current Plan A, outlined below is based on a “Healthy Only” framework for reopening the ACS campus. The “Healthy Only” framework requires parents and employees to ensure that **only healthy individuals are entering the campus**. To support and enforce this approach, parents will be required to sign a legally-binding waiver of liability and health screening agreement (See page 15 of this document). A “Healthy Only” framework provides the greatest level of "normalcy" but depends on parents, students and employees to remain at home if they display any flu-like symptoms or have been in contact with others who are symptomatic. Violators may lose their privilege to return to campus for the duration of the pandemic.

The school facilities will receive increased levels of cleaning and sanitizing, as well as increased containment of groupings of students for the purposes of contact tracing, which may be required at any time during the school year. However, the disruption to typical classroom routines will be minimized to the greatest extent possible in order to support student and staff socio-emotional health, as well as best-practices of instruction.

For Plan A, ACS will make every effort to provide distance learning accommodations for students with elevated health concerns, but we cannot guarantee these services. If ACS cannot provide these services, students will not have the opportunity for distance learning in Plan A.

⁴ <https://www.cdc.gov/coronavirus/2019-ncov/daily-life-coping/children/symptoms.html>



Albany Christian School

ACS Covid19 Prevention and Response Plan

Revised 10/30/2020

Re-Opening Plan at-A-Glance

The list below outlines the basic expectations that will be met ACS re-opens for the first day of school on September 9, 2020 for K-3 and in the near future when metrics are met for grades 4-8. The rest of this entire document provides more detail to daily protocols.

- Parents and staff will sign Waiver of Liability Form
- 5-day on site instruction for K-3 using Seesaw and Zoom if needed;
- 5-day on site instruction for grades 4-8 google Classroom and Zoom if needed
- Daily temperature checks before entering building
- Temperature checks will take place in the vehicle before parent drives away
- Students will enter/exit the building at specific grade level entry and exit doors
- Parents are NOT allowed on campus for drop off.
- Parents will say “goodbye” to student on sidewalk without entering building
- Hand sanitizer personal-size bottles will be provided by parents
- Hand sanitizer stations will be available upon entry for students and staff
- No hot food menus out of the cafeteria
- Masks/shields are required for everyone K-8
- Social distancing in place as much as possible
- Enhanced custodial cleanings
- Electrostatic Spraying for disinfectant purposes
- Create new role Health & Safety Coordinator
- Create new role Custodial Coordinator
- Classroom bottles of sanitizers
- Student personal 2oz. bottle of desk sanitizer supplied by parents
- Water fountains turned off- student personal water bottles supplied by parents
- Water bottle refill station installed
- No music class
- Library/Spanish in classroom
- Computer lab not in use
- No mixing of TEAMS
- \$100 per hour fee to supervise students with fever who are dropped off by parent who drives off prior to temperature check.
- In an effort to remain safe and to keep on site instruction in place, ACS will make a decision to close based on 5 levels of exposure – (See Closure on page 14)



Albany Christian School

ACS Covid19 Prevention and Response Plan

Revised 10/30/2020

Preventions

Prevention Plan Item	Prevention Protocols
Administration	<ul style="list-style-type: none"> • ACS will provide 1st day of school staff and student training on Covid19 symptoms and prevention • ACS will offer credit card tuition payment which will promote social distancing • To promote social distancing, ACS will offer automatic deduction option for paying tuition • Administration will add “personal-sized hand sanitizer” to ACS K-8 Classroom Supply Lists • Administration with or without a timely consult with parents and staff holds the authority to adjust this plan at any time as needed. • ACS will provide PPE as requested by staff • ACS staff will communicate closely with WCC staff to prevent cross contamination between church and school personnel and members/students.
Assemblies	<ul style="list-style-type: none"> • ACS will reduce the amount of non-essential assemblies and/or seek to maintain CDC guidelines for social distancing during assembly • ACS will attempt to adjust Chapel in individual classroom settings for K-3
Bathrooms	<ul style="list-style-type: none"> • Bathrooms will be allocated to certain grades Main Floor PS-K Upstairs 1-5 Basement 6-8 • Students will have a planned staggered bathroom schedule • Distance markers will be used to help students with social distancing • ACS will place monitors outside bathrooms during scheduled breaks to control usage • Bathroom handles will be sanitized after each class usage
Cafeteria	<ul style="list-style-type: none"> • ACS will discontinue cooking from the school kitchen due to it being a high-risk area • Boxed pre-packaged/bagged lunches from local restaurants may be offered • Meals, snacks & beverages served from the cafeteria must be individually packaged and served directly to the student • Classes will rotate between eating in the cafeteria and classrooms to accommodate physical distancing • Students in the K-8 program and in after school care will need to provide their own water bottles and snacks • Windows will be open when weather permits



Albany Christian School

ACS Covid19 Prevention and Response Plan

Revised 10/30/2020

	<ul style="list-style-type: none"> • Fans will be blowing to circulate air flow • Tables will be disinfected after each class use • Staff distributing any meals will wear a mask or face covering and gloves • ACS may utilize four grassy outdoor lunch areas preferred over the cafeteria
<p>Classrooms</p>	<ul style="list-style-type: none"> • K-8 students will receive Covid19 prevention instruction on the first day of school <ol style="list-style-type: none"> 1. Self-Identify as “high risk” 2. Hand washing – Soap & water for 20 seconds Before and after recess Before and after lunch 3. Facial coverings will be required K-8 4. Social Distancing in place where feasible 5. Personal property self-contained • Upon entering the K8 classroom students will sanitize their hands. • Desks will be distanced 6ft apart as much as possible • Desks will be facing same direction • Windows will be open when weather permits • Fans will be blowing to circulate air flow • All K8 classrooms will be equipped with hand sanitizer, disinfectant spray, wipes, and paper towels • Students will touch only their own learning materials (e.g. rulers, pencil boxes, pens). • Parents will provide students with a personal bottle of hand sanitizer at their desk • Teachers and students will be responsible for completing a Contact Tracing Log for the first four weeks of class • Backpack hooks will be alternately used with backpack on hook separated by backpack on floor • If a Teacher or student contracts Covid, the class will close and quarantine for two weeks and Distance Learning will be implemented for that class. Siblings will be identified and be quarantined as well and normal absence homework packets will be made available to siblings. • If multiple Teachers or students contract Covid, the school will close and quarantine for two weeks and Distance Learning will be implemented for the entire school.
<p>Entering/Exiting the Building</p>	<ul style="list-style-type: none"> • ACS will implement a daily temperature check for everyone entering the building • Hand sanitizing stations will be placed at entrances for students, parents, and visitors • Parents (PS-8th grade) will not be allowed on campus during drop-off or pick-up times • ACS will allocate specific entry and exit doors to facilitate movement through the building that promotes physical distancing. See charts at end of this document. • 3rd Ave will be the designated entrance open for temperature checks after the beginning of the school day from 9:00-4:00



Albany Christian School

ACS Covid19 Prevention and Response Plan

Revised 10/30/2020

- Students displaying a temperature over 100° F will not be allowed on campus
- Volunteers will not be allowed on campus

MORNING DROP OFF PROCEDURES:

General

- Child Care drop-off begins at 7:00am
- Students checking in after 9:00 AM must be delivered by the parent to the Main entrance on 3rd Avenue to receive a temperature check

Child Care

- All Child Care students will enter through the 4th Avenue SE doors.
- Child Care parents will drop off students & say goodbye on the sidewalk outside the building
- Classroom drop-off from Child Care to PS begins at 8:50 AM to go wash hands
- Child Care students will report directly to the classroom after hand-washing

Preschool

- Students will enter the building through the 4th Avenue SE doors.
- Child Care parents will drop off students & say goodbye on the sidewalk outside the building
- PS Teachers/aides will deliver kids to the classroom from the 4th Avenue SE entrance

Kindergarten

- Students will enter through the 4th Avenue SW doors. Parents will drop off students and say goodbye on the sidewalk outside the building. Students will enter the building, go up the stairs and go directly down the right side of the hallway to their classroom in room 102.

1st grade

- Students will enter through the Jackson Street gymnasium doors, travel through on the right side of the gym lobby and immediately go up the right side of the stairwell to their classroom in room 207 or room 209.

2nd grade

- Students will enter through the Jackson Street gymnasium doors, travel through on the right side of the gym lobby and immediately go up the right side of the stairwell to their classroom in room 208.

3rd grade



Albany Christian School

ACS Covid19 Prevention and Response Plan

Revised 10/30/2020

- Students will enter through the Main 3rd Avenue doors, turn right and go up the right side of the stairwell to their classroom in room 200.

4th grade

- Students will enter through the Main 3rd Avenue doors, turn left and go up the right side of the stairwell to their classroom in room 210.

5th grade

- Students will enter through the Railroad Street Worship Center doors and travel through the Worship Center lobby and go up on the right side of the stairwell to their classroom in room 202.

6th-8th grade

- Students will enter through the Railroad Street Worship Center doors and travel through the Worship Center lobby and go up on the right side of the stairwell to their classrooms, 201, or 203, or 204.

AFTER SCHOOL PICK UP PROCEDURES:

Child Care:

- Parents or designated person(s) will enter through the Main entrance on 3rd Avenue and make a request to the ACS staff member to pick up their child. The ACS staff member will retrieve the student and release him/her to the parent or designated person.

Preschool

- Students will be released to parents by class:
 - **Miss Kreisha** and **Mrs. Kaydi/Tosha** – 3rd Avenue
 - **Mrs. April** – Jackson Street
 - **Mrs. Emily** and **Miss Skylar** and **Miss Sue** – 4th Avenue

Kindergarten

- Students will be released to parents on the West end of the building on 4th Avenue

1st grade

- Students will be released to parents on Jackson Street at the gymnasium exit

2nd grade

- Students will be released to parents on Jackson Street at the gymnasium exit

3rd grade

- Students will be released to parents on 3rd Avenue at the main entrance walkway



Albany Christian School

ACS Covid19 Prevention and Response Plan

Revised 10/30/2020

	<p><u>4th grade</u></p> <ul style="list-style-type: none"> • Students will be released to parents on Railroad Street at the Worship Center doors <p><u>6th - 8th grade</u></p> <ul style="list-style-type: none"> • Students will be released to parents on Railroad Street at the Worship Center doors
Environmental Cleaning	<ul style="list-style-type: none"> • Cleaning requirements will be maintained according to section 2j of the <i>Ready Schools, Safe Learners</i> guidance. • Railings and door knobs will be disinfected throughout the day • Custodians will work an enhanced cleaning schedule
Equipment	<ul style="list-style-type: none"> • Computers, ipads, headphones, mice, keyboards, copiers, printers, microwaves, refrigerators, hand dollies, etc. will be sanitized after each use. • The Computer Lab will have limited use due to it being a high-risk area • Recess and PE equipment will be sanitized between each class usage • Playground will be sanitized after each use
Facility	<ul style="list-style-type: none"> • Common areas including the cafeteria will be cleaned & sanitized after each use • Evening janitorial staff will be responsible for cleaning and disinfecting handrails, door knobs, handles, door frames, and other frequently touched surfaces. • Classroom doors and windows, as well as non-fire hallway doors, will be kept open as much as possible to allow ventilation and airflow • Hand sanitizing stations will be placed at building entry points • Reminders will be displayed throughout the school (classrooms, hallways, bathrooms, administrative offices) for students and staff: <ol style="list-style-type: none"> 1. Social distancing 2. Proper and frequent handwashing 3. How to stop the spread of germs • Fire drills and lockdown drills will be modified to maintain proper physical distancing to the greatest extent possible <ol style="list-style-type: none"> 1. Non-alarmed practice drills – classrooms on opposite sides of building
Guests, Parents, & Visitors	<ul style="list-style-type: none"> • All guests, parents, and visitors are required to complete a temperature screening prior to entry of building • All guests, parents, and visitors will be limited on campus • All guests, parents, and visitors are required to wear a mask or face covering while on campus • Grade 1-8 parents are not permitted to enter the building during drop-off or pick-up times • Volunteers in the classroom will not be allowed during COVID safety measures



Albany Christian School

ACS Covid19 Prevention and Response Plan

Revised 10/30/2020

<p>Hallways</p>	<ul style="list-style-type: none"> • Water fountains will not be operational. (We are exploring the possibility of converting at least one of our water fountains into bottle-filling stations) • Monitors in be in hallways to help students with social distancing • Distance markers will be used to help students with social distancing • Monitors will be in hallways outside bathrooms to control usage
<p>Health Screening</p>	<ul style="list-style-type: none"> • Temperatures of all persons (e.g. students, employees, parents) will be checked prior to entering the campus • Smell sensation may be checked of persons (e.g. students, employees, parents) who exhibit Covid-like symptoms • Parents and employees must complete a Waiver of Liability and Health Screening Agreement at the beginning of the school year with required signatures for their understanding of the limitations of ACS physical distancing capabilities and releasing ACS/WCC of any liability in regards to Covid-19 and agreeing to only permit non-symptomatic persons to enter the campus (See page 15 of this document) • It is recommended that any person who has traveled out of the country or to a Covid-19 “hot spot” self-quarantine for no less than 14 days at home with no symptoms appearing prior to returning to school • Any person who exhibits a fever above 100° will not be allowed on campus • Any student on campus who exhibits a fever above 100° will be held in the isolated sick room and parents will be notified to pick up their child • Any employee that exhibits a fever over 100° will be directed to leave campus immediately • If a student/staff presents any possible COVID-19 symptoms, the ACS Health and Safety Coordinator will complete the assessment and notify parents/staff to be sent home • If a student/staff member has a negative COVID-19 test, they must provide a doctor’s note and have had no fever without the use of fever-reducing medicines for 72 hours before they can return to school • In order for a student/staff who tested positive for COVID-19 to be allowed to return to campus they must be able to answer YES to the following questions: <ul style="list-style-type: none"> Has it been at least 10 days since the individual first had symptoms? Has it been at least 3 days since the individual had a fever (without using fever-reducing medicine)? Has it been at least 3 days since the individual’s symptoms have improved including cough and/or shortness of breath? • Absences due to Health Screening restrictions will not be counted as school day absences
<p>Closure Instructional</p>	<p><u>Closure:</u></p>



Albany Christian School

ACS Covid19 Prevention and Response Plan

Revised 10/30/2020

<p>Strategies</p>	<ul style="list-style-type: none"> • Distance Learning will be implemented for the school for any two week closure period or longer. • No provisions will be made for a 2-3 day closure, We will consider those closure days as “snow days” • Protocols and practices to ensure a high level of engagement in learning will be in place to support home-based learning <ul style="list-style-type: none"> Consistent face time learning Standardized Seesaw/Google Classroom Format Consistent Standardized attendance policy Consistent Standardized grading policy <p><u>Software:</u></p> <ul style="list-style-type: none"> • In order to ensure a smooth transition at any time that the school may need to shift to distance learning, teachers will be proficient in the use of the following online tools: • Seesaw: We will use Seesaw as our Distance Learning Platform for grades K-2 for posting assignments and communications regarding assignments • Google Classroom: We will use Google Classroom (GC) as our Distance Learning Platform for grades 3-8. GC will be used for posting all assignments and communications regarding assignments • Sycamore: We will continue to use Sycamore as our Student Information System for posting all grade-book information as well as all parent communication. • ZOOM: We will use Zoom as our Virtual Teaching System (VTS). Zoom is a dynamic instructional platform <p><u>Electronics:</u></p> <ul style="list-style-type: none"> • In the case of Plan B, a limited number of ipads and laptops will be made available to students in need • Shared equipment in computer labs will be maintained with a protocol of surface cleaning between every use
<p>Lost and Found</p>	<ul style="list-style-type: none"> • This year, it will be very important for all school items, including jackets and other items of clothing, to be labeled with the first and last name of the student • All lost items will be secured in the Nurse’s office where the items will be held for only one week • After one week, items will be donated to a local charity
<p>Masks/Face coverings</p>	<ul style="list-style-type: none"> • The wearing of face coverings is required for everyone on campus • Our first student orientation of the school year will include education for our students on safety precautions including face coverings • Our desire is to be an environment where all people are comfortable within this community, embraced through the love of Jesus, regardless of outer appearance



Albany Christian School

ACS Covid19 Prevention and Response Plan

Revised 10/30/2020

<p>Personal Items</p>	<ul style="list-style-type: none"> • All personal items brought to the school by a student or employee must be disinfected daily by the owner prior to being introduced on campus • No personal items may be shared (e.g., backpacks, clothing) • Learning materials may be shared once disinfected (e.g. manipulatives, ipads) • All personal items must be labeled with the student’s name (e.g. water bottles, notebooks, backpacks) • Students may not touch or use another student’s locker, backpack, or any other item without first disinfecting the item 																														
<p>Physical Distancing</p>	<ul style="list-style-type: none"> • ACS will support physical distancing in all daily activities and instruction, striving to maintain at least six feet between individuals. In the case of “physical space limitation” in which a six foot distance cannot be maintained between students, especially in an enclosed classroom environment, ACS will seek consent from parent in order to maintain the maximum teacher to students ratio (1:24) per classroom <p><u>Classroom:</u></p> <ul style="list-style-type: none"> • Teams will be designed such that all students (including those protected under ADA and IDEA) maintain access to general education, grade level learning standards, and peers. To maintain access to general education, grade level learning standards, and peers, TEAMS will be formed into the following groups: <table border="0" data-bbox="391 1178 1187 1570"> <tr> <td>• TEAM #1</td> <td>Kindergarten AM</td> <td>Mrs. Elliott</td> </tr> <tr> <td>• TEAM #2</td> <td>Kindergarten PM</td> <td>Mrs. Elliott</td> </tr> <tr> <td>• TEAM #3</td> <td>1st Grade</td> <td>Miss Johnson/Mrs. Cook</td> </tr> <tr> <td>• TEAM #4</td> <td>2nd Grade</td> <td>Mrs. Guthrie</td> </tr> <tr> <td>• TEAM #5</td> <td>3rd Grade</td> <td>Ms. Wilke</td> </tr> <tr> <td>• TEAM #6</td> <td>4th Grade</td> <td>Mrs. Looney</td> </tr> <tr> <td>• TEAM #7</td> <td>5th Grade</td> <td>Mrs. Tharp</td> </tr> <tr> <td>• TEAM #8</td> <td>6th Grade</td> <td>Mr. Clarke</td> </tr> <tr> <td></td> <td>7th Grade</td> <td>Mr. Reeves</td> </tr> <tr> <td></td> <td>8th Grade</td> <td>Ms. Hunter</td> </tr> </table> <ul style="list-style-type: none"> • Students will be instructed not to share items with their classmates • Desks will be spaced apart to maximize social distancing space • Desks will be arranged forward-facing so that students are not face to face <p><u>P.E. & Recess:</u></p> <ul style="list-style-type: none"> • Contact sports will not be permitted during Physical Education classes or Recess 	• TEAM #1	Kindergarten AM	Mrs. Elliott	• TEAM #2	Kindergarten PM	Mrs. Elliott	• TEAM #3	1st Grade	Miss Johnson/Mrs. Cook	• TEAM #4	2nd Grade	Mrs. Guthrie	• TEAM #5	3rd Grade	Ms. Wilke	• TEAM #6	4th Grade	Mrs. Looney	• TEAM #7	5th Grade	Mrs. Tharp	• TEAM #8	6th Grade	Mr. Clarke		7th Grade	Mr. Reeves		8th Grade	Ms. Hunter
• TEAM #1	Kindergarten AM	Mrs. Elliott																													
• TEAM #2	Kindergarten PM	Mrs. Elliott																													
• TEAM #3	1st Grade	Miss Johnson/Mrs. Cook																													
• TEAM #4	2nd Grade	Mrs. Guthrie																													
• TEAM #5	3rd Grade	Ms. Wilke																													
• TEAM #6	4th Grade	Mrs. Looney																													
• TEAM #7	5th Grade	Mrs. Tharp																													
• TEAM #8	6th Grade	Mr. Clarke																													
	7th Grade	Mr. Reeves																													
	8th Grade	Ms. Hunter																													



Albany Christian School

ACS Covid19 Prevention and Response Plan

Revised 10/30/2020

	<p>times.</p> <ul style="list-style-type: none"> • Staff will plan recreational and sports activities that minimize physical contact with minimal equipment sharing • Equipment will be cleaned and sanitized after each class use <p><u>Facilities:</u></p> <ul style="list-style-type: none"> • Reminders will be displayed throughout the school (classrooms, hallways, bathrooms, administrative offices) for students and staff: <ul style="list-style-type: none"> Stay 6' apart when possible Proper and frequent handwashing How to stop the spread of germs • Fire drills and lockdown drills will be modified to maintain proper physical distancing to the greatest extent possible. • Chapel will be reorganized to accommodate minimal contact between classes • ACS Worship Center will be sanitized between each chapel group
Recess	<ul style="list-style-type: none"> • ACS playground will remain closed to general public but available for ACS recesses • Recess schedules will accommodate one TEAM at a time on the playground. • Playground will be sanitized between each class use • Students will wash their hands before and after recess • ACS may utilize the Gym/Cafeteria/Playground/Gym Lobby to accommodate the need for recess areas
Water	<ul style="list-style-type: none"> • Students will bring their own water bottles labeled with their name. • If a student does not bring a water bottle, a disposable water bottle will be provided and the student's account will be charged \$1.00 accordingly



Albany Christian School

ACS Covid19 Prevention and Response Plan

Revised 10/30/2020

Exposure

<p>Isolation</p>	<ul style="list-style-type: none"> • ACS has created a Health and Safety Coordinator (HSC) position to be better prepared to handle potential health needs of our students and staff this year. The HSC office is located in the gymnasium lobby. Students and/or staff with Covid19 symptoms will be directed to this office • If a student/staff member is sent home due to fever, he/she must immediately contact his/her primary care provider or other appropriate health care professional and monitor symptoms • The student/staff member must be fever free for 72 hours before returning to school • The ACS HSC will track and monitor students/staff who are sent home with a fever to ensure compliance
<p>Symptoms</p>	<ul style="list-style-type: none"> • Any person showing a temperature greater than 100° F will not be allowed on campus • If a student on campus shows symptoms of Covid19 with a fever (https://www.cdc.gov/coronavirus/2019-ncov/symptoms-testing/symptoms.html), he/she will be isolated in/at or near the Health and Safety Coordinator’s office and a parent will be called to immediately come and pick up the student from the Jackson Street gymnasium entrance
<p>Reporting</p>	<ul style="list-style-type: none"> • If anyone who has been on campus is known to have been diagnosed with COVID-19, the ACS HSC will report the case to and consult with the Local Public Health Authority (LPHA) • If such a case of Covid19 is identified in the ACS school setting, and the incidence is low, the Local Public Health Authority (LPHA) will provide a direct report to the ACS Health & Safety Coordinator on the diagnosed case(s) and receive guidelines regarding cleaning and program closure • In such a case that the LPHA diagnoses a Covid19 case in the ACS setting, the ACS HSC will communicate with parents • In such a case that the LPHA diagnoses a “low incident” Covid19 case in the ACS setting, ACS will close for 2-5 days and implement an all-school cleaning protocol • In such a case that the LPHA diagnoses a Covid19 case in the ACS setting, and the incidence is high, ACS HSC will report the cases to and consult with the Local Public Health Authority (LPHA) regarding program closure and the implementation of Plan B, distance learning for all students until further notice
<p>Closure</p>	<ul style="list-style-type: none"> • Should a closure of an indefinite amount of time result from either a direct Covid19 case on campus or due to governmental restrictions, ACS will be prepared to offer distance learning to all students.



Albany Christian School

ACS Covid19 Prevention and Response Plan

Revised 10/30/2020

ACS will have 5 levels of closure:

● CLOSURE LEVELS

Level 1

If one student in a classroom contracts Covid, the student will quarantine for 14 days and the teacher will monitor the class for further symptoms. The class will be electrostatically cleaned.

- Sibling(s) of Covid case will be identified and be quarantined as well

Level 2

If multiple students in the same classroom contract Covid, the entire school will close for cleaning and the affected classroom will close and quarantine for two weeks. All other classes will return to school after the cleaning period.

- Distance Learning will be provided for students in the quarantined classes
- No instruction will be provided for students during the cleaning days – “snow days”

Level 3

If any ACS staff member contracts Covid, the entire school will close for cleaning, and the affected classroom will quarantine for two weeks. All other classes will return to school after the cleaning period.

- Distance Learning will be provided for students in the quarantined class
- No instruction will be provided for students during the cleaning days – “snow days”

Level 4

If multiple staff contract Covid in the same classroom, the entire school will close for cleaning and the affected classroom will close and quarantine for two weeks. All other classes will return to school after cleaning period.

- Distance Learning will be provided for students in the quarantined class
- No instruction will be provided for students during the cleaning days – “snow days”

Level 5

If multiple staff contract Covid in different classrooms, the entire school will close for cleaning and will quarantine for two weeks.

- Distance Learning will be provided for students



Albany Christian School

ACS Covid19 Prevention and Response Plan

Revised 10/30/2020

Kindergarten & Preschool/Child Care Drop-Off Locations

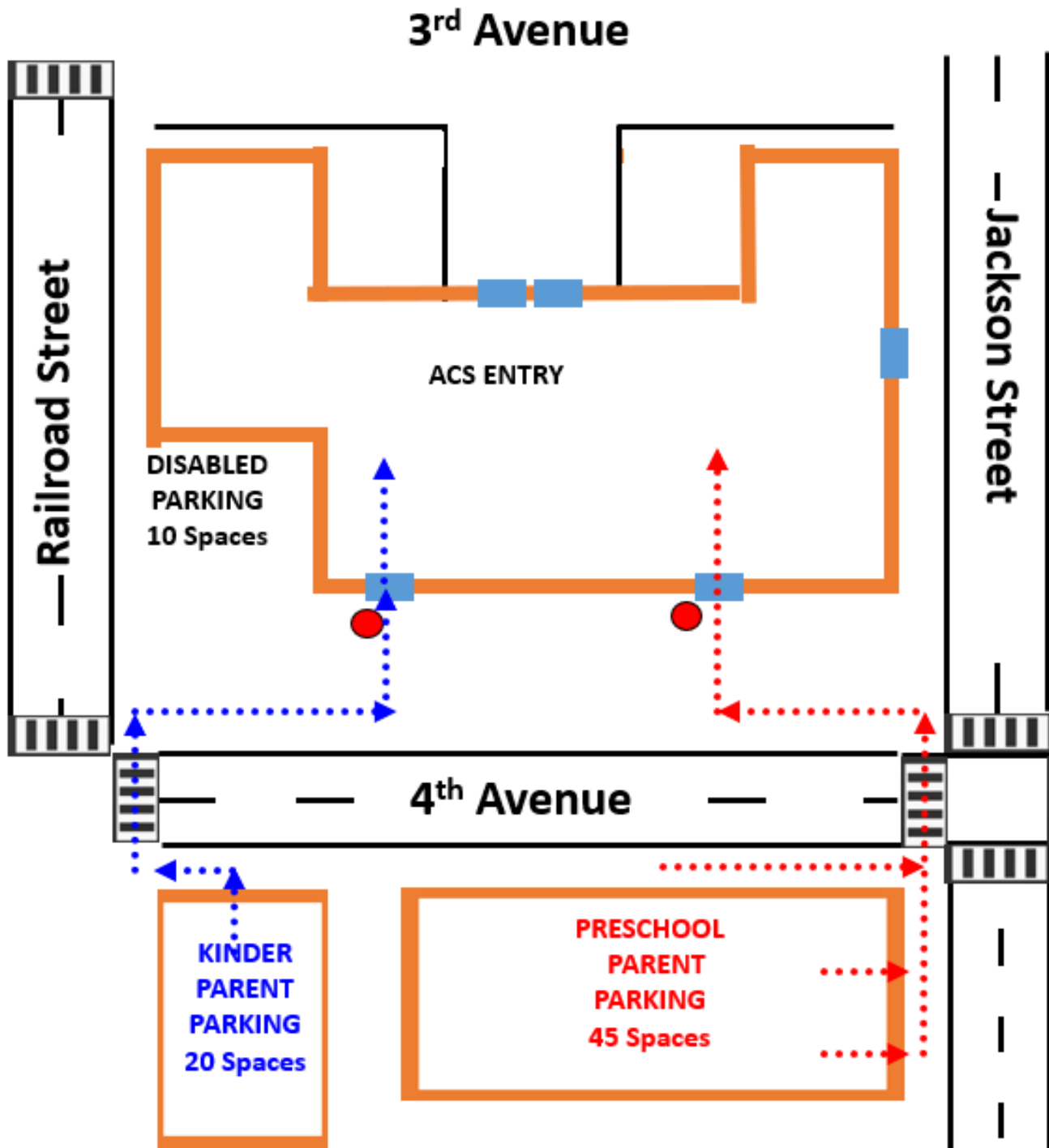



Albany Christian School

ACS Covid19 Prevention and Response Plan

Revised 10/30/2020

Kindergarten & Preschool/Child Care Pick-Up Locations

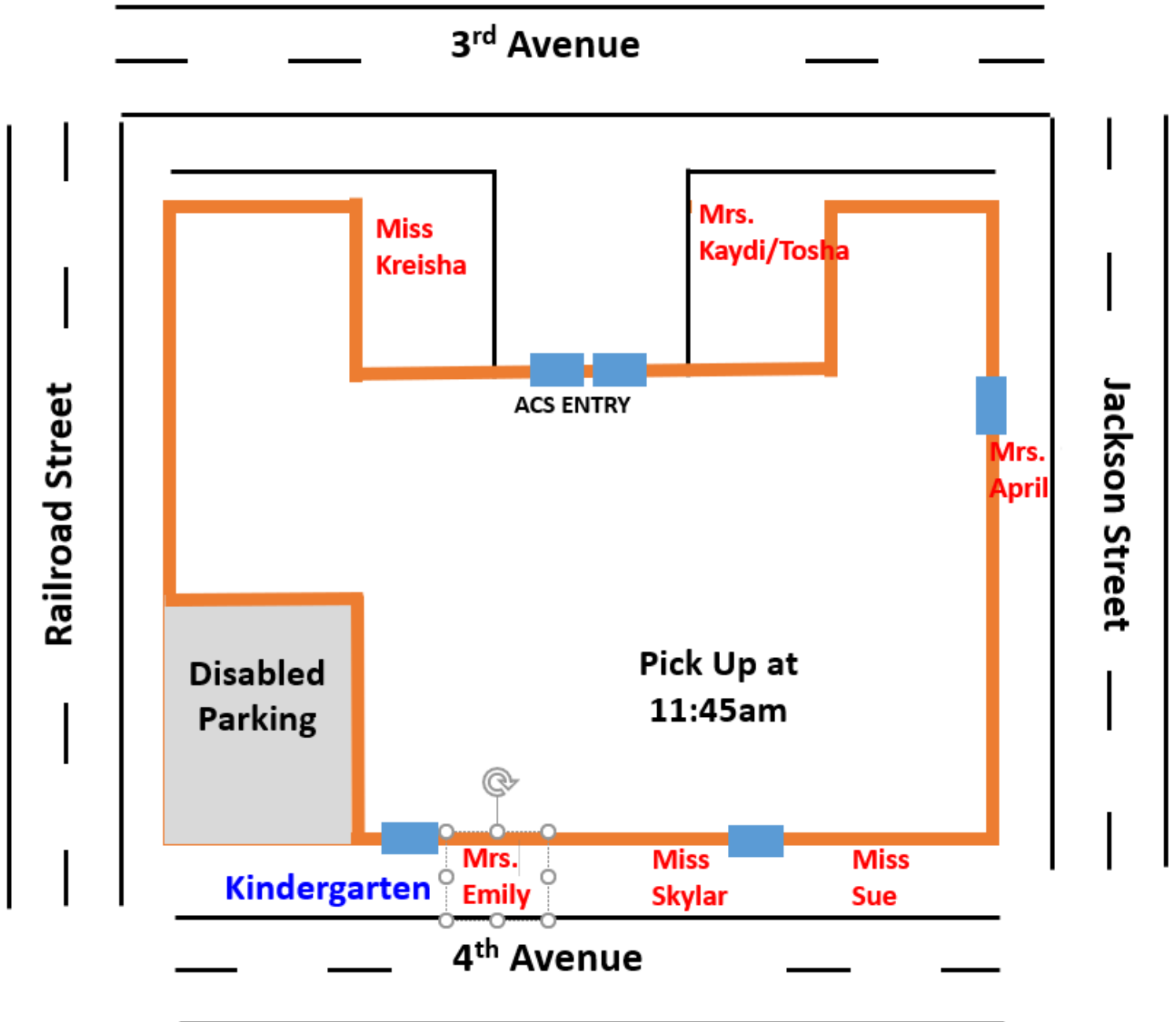



Albany Christian School

ACS Covid19 Prevention and Response Plan
Revised 10/30/2020

K-8 Drop-Off Locations

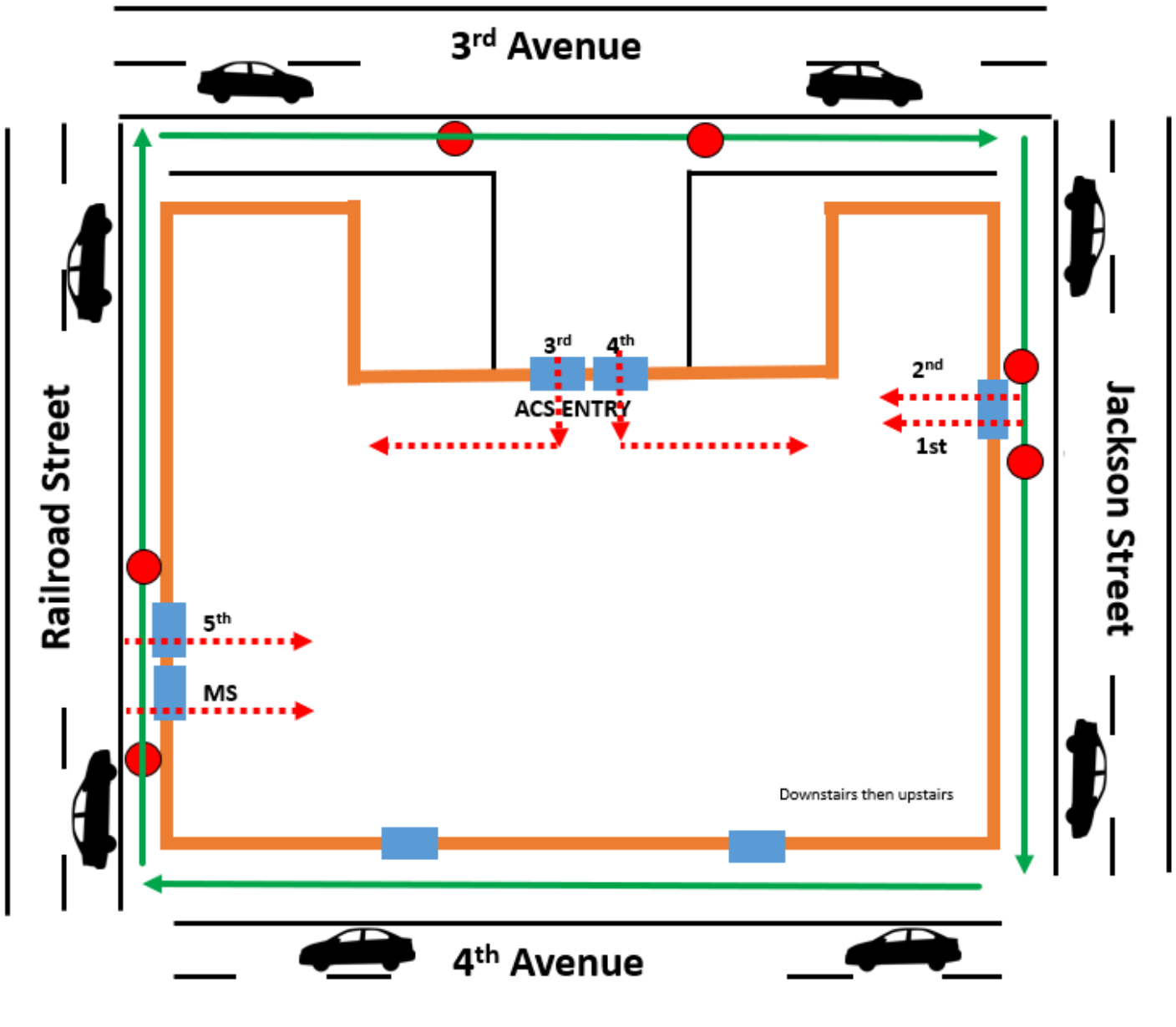



Albany Christian School

ACS Covid19 Prevention and Response Plan

Revised 10/30/2020

K-8 Pick-Up Locations

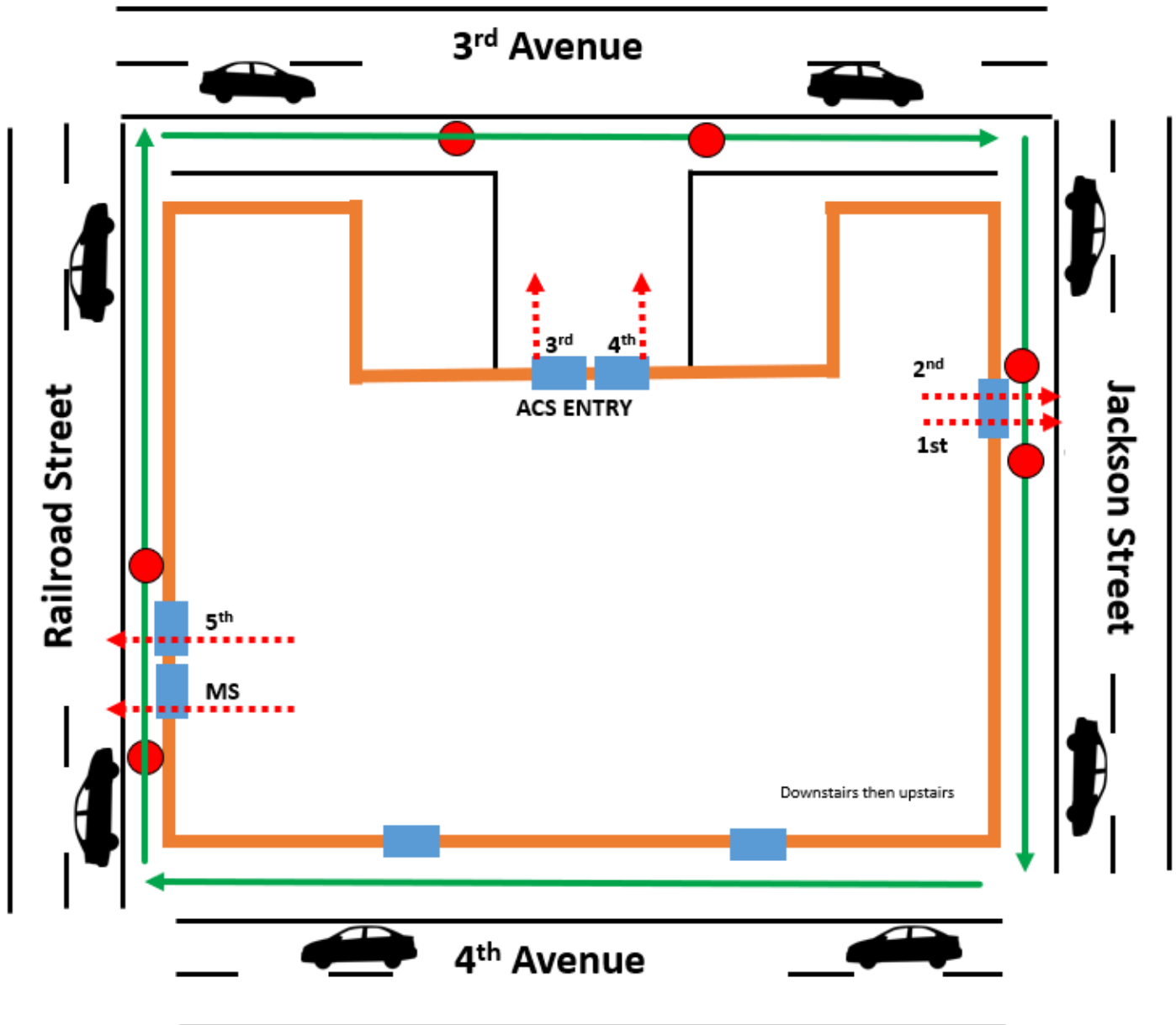

ACS Student Daily Contact Tracing Log

Grades K-2 Teachers will record daily contact tracing logs for a minimum of four weeks to assist the LPHA as needed. HSC will review daily.

Grades 3-8 Students will record daily contact tracing logs to assist the LPHA as needed. Aides will review daily and HSC will review weekly.

- Copy per student
- Contact per day
- Template
- Daily Routine
- Aide Daily Review
- HSC Review Weekly

- Student Name _____ Date ___/___/___
- Drop Off Time _____ Location _____ Pick Up Time _____ Location _____
- Parent/Guardian Name _____
- Emergency Contact Information _____
 Teacher Phone ___/___-_____
 Teacher Aide Phone ___/___-_____

Monday ___/___/___	Tuesday ___/___/___	Wednesday ___/___/___	Thursday ___/___/___	Friday ___/___/___
Other Contacts Today: _____ _____ _____ _____ _____ _____ _____	Other Contacts Today: _____ _____ _____ _____ _____ _____ _____	Other Contacts Today: _____ _____ _____ _____ _____ _____ _____	Other Contacts Today: _____ _____ _____ _____ _____ _____ _____	Other Contacts Today: _____ _____ _____ _____ _____ _____ _____

PLEASE TELL ME HOW YOU FEEL TODAY

- | | | | | | | |
|-------------|----------------|---------------|--------------------|---------------|------------------------|-------------|
| A. FEVER | B. CHILLS | C. COUGH | D. HARD TO BREATHE | E. TIRED | F. SORE | G. HEADACHE |
| H. VOMITING | I. SORE THROAT | J. CONGESTION | K. DIARRHEA | L. RUNNY NOSE | M. LOSS OF TASTE/SMELL | |
| N. SAD | O. AFRAID | P. NERVOUS | Q. HAPPY | R. CONFUSED | S. LONELY | |

<u>Monday</u>	<u>Tuesday</u>	<u>Wednesday</u>	<u>Thursday</u>	<u>Friday</u>

WAIVER OF LIABILITY AND

Albany Christian School and Willamette Community Church (ACS/WCC) is hereby providing notice to me that it intends to reopen its school program on Wednesday, September 9, 2020. I/we understand that ACS/WCC cannot protect my child/student and/or me from risks, which may be encountered as a result of my child attending the school and/or participating in any school-sponsored program. I/we realize there are natural, mechanical, and environmental conditions and hazards which independently or in combination with any activities engaged in while participating in this program may result in the exposure to certain risks including exposure to coronavirus (COVID-19), or other biological agents, virus or similar bacteriological agent, and the risk of being quarantined, or illness that may result in medical care, hospitalization or death.

I hereby state that I, on behalf of my child/student, myself and my extended family, am an adult, over the age of 18, and legally competent to sign this form. I understand these inherent risks and dangers involved with participation in the school providing their services and acknowledge the existence of risks which are not obvious or predictable, and hereby intend this release to extend to injury or loss which results from both obvious or predictable risks, as well as risks that are unpredictable and not obvious and to extend to myself and my child/student, as applicable.

I hereby agree not to enter the campus of ACS/WCC nor permit my child/student or designated person/s to enter the campus of ACS/WCC if I/they have exhibited or have been in contact with another person who has exhibited any of the symptoms currently listed by the Center for Disease Control and Prevention as Symptoms of Coronavirus within the previous 14 days.

Furthermore, I understand the physical limitations of some of the school classrooms and I agree with the ACS strategy to maintain the 1:24 teacher to student ratio per classroom. I agree that the physical limitations of some ACS classrooms prevent a 35sq.ft. distance per student in the classroom, and I agree to enroll my student knowing these physical limitations.

In consideration of myself and my child/student, I/we, and any legal representatives, heirs and assigns, hereby release, waive, and discharge Albany Christian School, its officers, Board of Directors, employees, agents, and representatives from all liability for any loss or damage, and any claim or damages resulting therefrom, on account of any injury, illness or exposure to and/or contracting the coronavirus (COVID-19) or other biological agents, virus or similar bacteriological agent by me or my child/student attendance at and participation in the preschool and/or afterschool program, including any medical expenses, injury and/or death.

I agree to indemnify Albany Christian School and Willamette Community Church, its officers, directors, employees, agents, and representatives from any loss, liability, damage, or cost that may be incurred due to my child/student participation in the aforementioned program, whether caused by the negligence of ACS/WCC or otherwise. I fully understand, on my behalf and behalf of my child/student, the risks associated with the aforementioned participation and assume any risk associated therewith.

This notice, release and indemnity agreement contains the entire agreement between and among the parties hereto, and the terms of this release are contractual and not a mere recital.

The parties to this agreement hereby agree that the interpretation and enforceability of this Release shall be governed by the laws of the State of Oregon.

I expressly agree that this release, waiver, and indemnity agreement is intended to be as broad and inclusive as permitted by applicable laws and that if any portion thereof is held invalid, it is agreed that the balance shall, notwithstanding, continue in full legal force and effect.

I understand that by signing this agreement, I am giving up on behalf of my child/student, extended family, designated person/s and myself certain legal rights and remedies including the right for my child/student, my extended family, designated person/s, and/or myself, to recover damages in the event of death, personal and/or bodily injury of any kind, property loss or damage, expenses of any nature whatsoever including attorney's fees, and other losses that my student(s) or that I may sustain in association with my child's participation in the program.

Finally, I understand that should the school be required to offer Distance Learning at any time, I will be expected to continue to pay my monthly tuition bill per contracted agreement unless financial aid is offered by the school Board and an alternate agreement is made through the school Finance Department.

I HAVE CAREFULLY READ THE FOREGOING RELEASE AND KNOW AND UNDERSTAND THE CONTENTS THEREOF. I SIGN THIS RELEASE VOLUNTARILY AS MY FREE ACT WITH FULL KNOWLEDGE OF ITS SIGNIFICANCE, INTENDING TO BE LEGALLY BOUND THEREBY.

Parent Name _____

Parent Signature _____ Date
____/____/_____